

GENERAL NOTES:

REVISIONS:

NO.	REVISION	DATE

Construction Notes:

- All construction shall conform to the Dnratio Building Code.
- All doors and windows sizes shall be confirmed & approved by owner or contractor prior to construction.
- Contractor shall verify all conditions and dimensions prior to construction and be solely responsible for any changes necessary as a result of conditional or dimensional differences.
- Verify all dimensions on site.
- All dimensions are taken from the exterior face of wood framing or outside of concrete.
- Any substitution of materials or spans shall conform to the Dnratio Building Code.
- Install floor joists or wood blocking under non-loadbearing walls that run parallel to floor joist.
- Provide solid wood blocking under all point loads.
- Concrete foundations walls and footings shall have a compressive strength of 15MPa after 28 days.
- Unreinforced concrete garage and carport floors and all flat work shall have a compressive strength of 32 MPa after 28 days
- Stair dimensions shall conform to D.B.C. 98.3(1) & Table 98.3.1

ROOF CONSTRUCTION

- ATTIC ACCESS HATCH TO BE MIN. 510mm x 710mm (20" x 28") INSULATE AND WEATHERSTRIP.
- PROVIDE EAVE PROTECTION TYPE 'M' OR 'S' ROLL ROOFING OR EQUIVALENT, EXTENDING FROM THE EDGE OF THE ROOF A MIN. DISTANCE OF 300mm (36") UP THE ROOF SLOPE TO A LINE 1200mm (12') INSIDE THE INNER FACE OF THE EXTERIOR WALL.
- START STRIP NO. 85: 4.2 kg/m² ROLL ROOFING OR EQUIVALENT WITH LAPS FACING UP.
- HP AND VALLEY RAFTERS TO BE 50mm (2") DEEPER THAN COMMON RAFTERS.
- ROOF SHEATHING 11mm (7/16") ASPENITE C/W CLIPS
- ROOF EDGE SUPPORTS TO BE 38mm x 38mm (2" x 2") BLOCKING MIN.
- TRUSS BRIDGING PROVIDE 19mm x 89mm (1" x 4") CONT. AT EACH 2135mm (7'-0") o.c.
- PROVIDE 38mm x 89mm (2" x 4") WALL TIES ACROSS JOINTS OR BOTTOM TRUSS CHORD. MIN. 1220mm (4'-0") o.c. FOR ROOF SLOPES 4/12 OR GREATER.

- Min. Run = 4'
- Max. Tread Depth = 14'
- Min. Tread Depth = 12'
12. Guards for all stairs and decks shall conform to D.B.C. 91.8 & 90-7
13. Stairwell headroom in a dwelling unit shall be min. 6'-5" measured vertically conform to D.B.C. 98.3(4.1)
14. Carbon Monoxide detectors within dwelling units shall conform to D.B.C. 93.3(4.2)(2)(a),(2)(3).
15. All smoke alarms within dwelling units shall conform to D.B.C. 91.0(8.4)(1)
16. All Electrical equipment & facilities within of dwelling units shall conform to D.B.C. 93.4(1.2)(1)

Ruyf Drafting & Design Inc.

 AutoCAD Drafting • Design
 Graphic Architectural Perspectives
 RR2 Mountain, On. K0E 1S0 613-989-3232

Project: **"The Murdock" Model Home**
 Client: **ROBINSON CUSTOM HOMES**

Drawing Title: **MAIN FLOOR PLAN**
1575 SQUARE FEET

Scale: **1/8" = 1'-0"**
 Date: **APRIL, 2011**

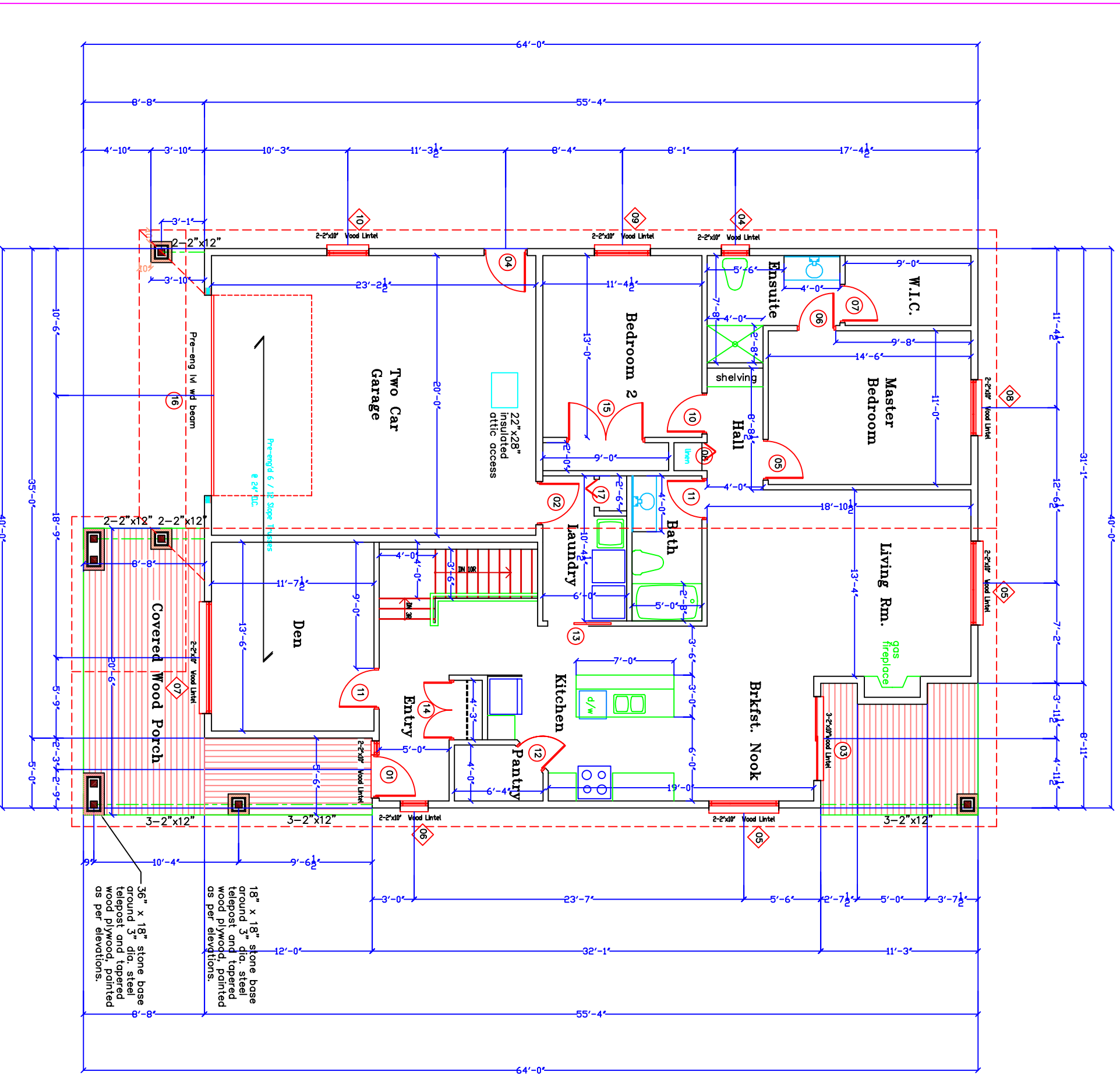
Drawn By: **G. RUYF**
 Checked By: _____
 Approved By: _____
 Drawing No. _____
A2 of 5



18" x 18" stone base around 3" dia. steel telepost and tapered wood plywood, painted as per elevations.

36" x 18" stone base around 3" dia. steel telepost and tapered wood plywood, painted as per elevations.